

Алматы (7273)495-231  
 Ангарск (3955)60-70-56  
 Архангельск (8182)63-90-72  
 Астрахань (8512)99-46-04  
 Барнаул (3852)73-04-60  
 Белгород (4722)40-23-64  
 Благовещенск (4162)22-76-07  
 Брянск (4832)59-03-52  
 Владивосток (423)249-28-31  
 Владикавказ (8672)28-90-48  
 Владимир (4922)49-43-18  
 Волгоград (844)278-03-48  
 Вологда (8172)26-41-59  
 Воронеж (473)204-51-73  
 Екатеринбург (343)384-55-89

Ижевск (3412)26-03-58  
 Иваново (4932)77-34-06  
 Иркутск (395)279-98-46  
 Казань (843)206-01-48  
 Калининград (4012)72-03-81  
 Калуга (4842)92-23-67  
 Кемерово (3842)65-04-62  
 Киров (8332)68-02-04  
 Коломна (4966)23-41-49  
 Кострома (4942)77-07-48  
 Краснодар (861)203-40-90  
 Красноярск (391)204-63-61  
 Курск (4712)77-13-04  
 Курган (3522)50-90-47  
 Липецк (4742)52-20-81

Магнитогорск (3519)55-03-13  
 Москва (495)268-04-70  
 Мурманск (8152)59-64-93  
 Набережные Челны (8552)20-53-41  
 Нижний Новгород (831)429-08-12  
 Новокузнецк (3843)20-46-81  
 Ноябрьск (3496)41-32-12  
 Новосибирск (383)227-86-73  
 Ноябрьск (3496)41-32-12  
 Омск (3812)21-46-40  
 Орел (4862)44-53-42  
 Оренбург (3532)37-68-04  
 Пенза (8412)22-31-16  
 Петрозаводск (8142)55-98-37  
 Псков (8112)59-10-37

Пермь (342)205-81-47  
 Ростов-на-Дону (863)308-18-15  
 Рязань (4912)46-61-64  
 Самара (846)206-03-16  
 Саранск (8342)22-96-24  
 Санкт-Петербург (812)309-46-40  
 Саратов (845)249-38-78  
 Севастополь (8692)22-31-93  
 Симферополь (3652)67-13-56  
 Смоленск (4812)29-41-54  
 Сочи (862)225-72-31  
 Ставрополь (8652)20-65-13  
 Сыктывкар (8212)25-95-17  
 Сургут (3462)77-98-35  
 Тамбов (4752)50-40-97

Тверь (4822)63-31-35  
 Тольяти (8482)63-91-07  
 Томск (3822)98-41-53  
 Тула (4872)33-79-87  
 Тюмень (3452)66-21-18  
 Улан-Удэ (3012)59-97-51  
 Ульяновск (8422)24-23-59  
 Уфа (347)229-48-12  
 Хабаровск (4212)92-98-04  
 Чебоксары (8352)28-53-07  
 Челябинск (351)202-03-61  
 Череповец (8202)49-02-64  
 Чита (3022)38-34-83  
 Якутск (4112)23-90-97  
 Ярославль (4852)69-52-93

Киргизия (996)312-96-26-47

Россия (495)268-04-70

Казахстан (772)734-952-31

<https://galliccassina.nt-rt.ru> || [gnj@nt-rt.ru](mailto:gnj@nt-rt.ru)

# Клапаны со смазкой стандартного типа двусторонняя полная оболочка ANSI 150-300 Lb

## ANSI Class 300 (PN 50)

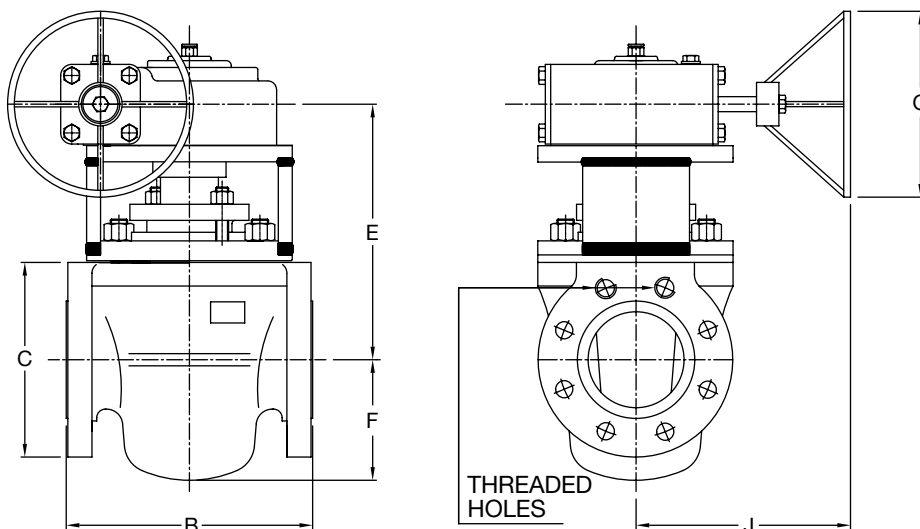

SCR 03R - Short with Gear

### Short Pattern

Size	NPS DN	5 125	6 150	8 200	10 250	12 300	
FACE TO FACE	B	mm	254	403	419	457	502
FLANGE DIAMETER DIN PN 40	C	mm	270	300	375	450	515
FLANGE DIAMETER ANSI 300 RF	C	mm	280	318	381	445	521
CENTER LINE TO CENTER OF HANDWHEEL	E	mm	550	575	600	630	690
CENTER LINE TO BOTTOM OF BODY	F	mm	155	160	194	240	260
HANDWHEEL DIAMETER	G	mm	560	560	560	560	560
LONGITUDINAL CENTER LINE TO FACE OF HANDWHEEL	J	mm	330	330	330	450	450
WEIGHT PN 40		kg	110	145	210	240	320
WEIGHT ANSI 300		kg	118	155	225	255	340

## Section 2 - Two Way Full Jacketed (Oversized Flanges)



## Full Bore Type Jacketed (Oversized Flanges)

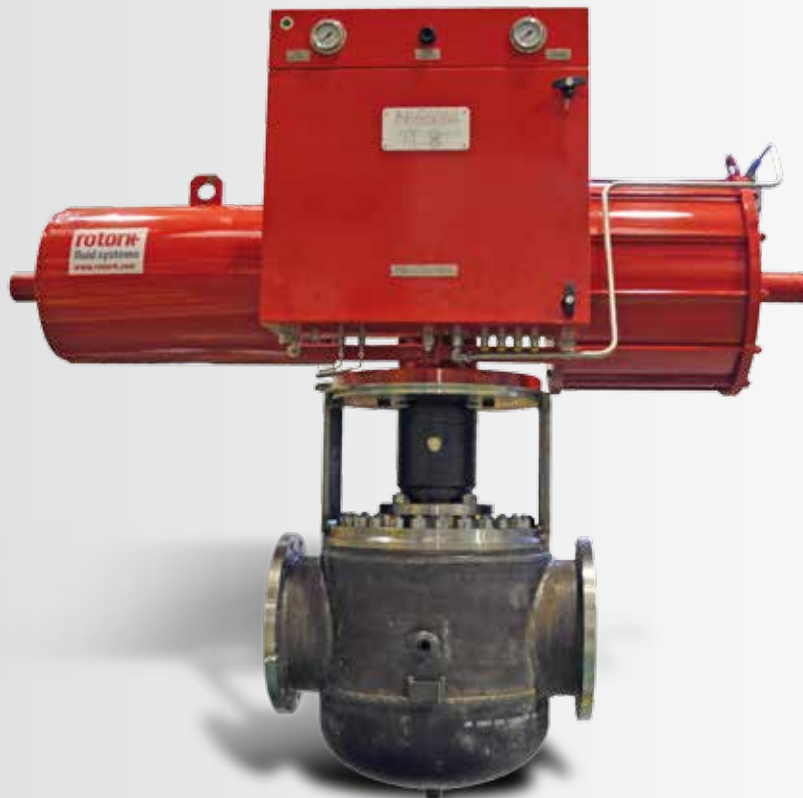

# ANSI Class 150 (PN 20)

## Steam Jacketed Body

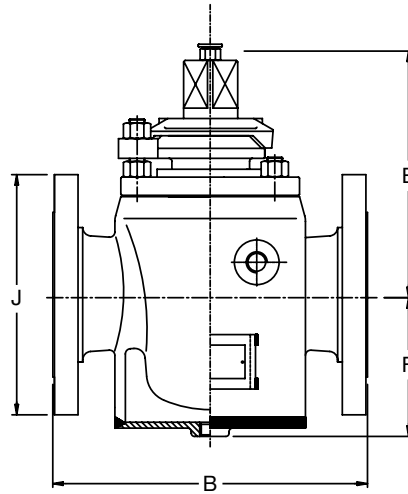

VCC 01R - Short with Wrench

Size	NPS DN	Short Pattern				
		2 50	2½ 65	3 80	4 100	6 150
FACE TO FACE ANSI 150 RF	<b>B</b> mm	178	191	203	229	267
FLANGE DIAMETER PN 16	<b>C</b> mm	165	185	200	220	285
FLANGE DIAMETER ANSI 150	<b>C</b> mm	152	178	191	229	279
N. TAPPED HOLES UNC THREADED IN FLANGES		-	-	-	-	2
CENTER LINE TO TOP OF STEM	<b>E</b> mm	152	176	207	230	300
CENTER LINE TO BOTTOM OF BODY	<b>F</b> mm	103	115	136	151	210
STEAM/CONDENSATE N. HOLES ¾" N.P.T.	<b>P</b>	3	3	3	3	3
WEIGHT	kg	16	24	31	43	105
WRENCH - LENGHT	mm	320	400	500	570	1010

# ANSI Class 150 (PN 20)

## Steam Jacketed Body

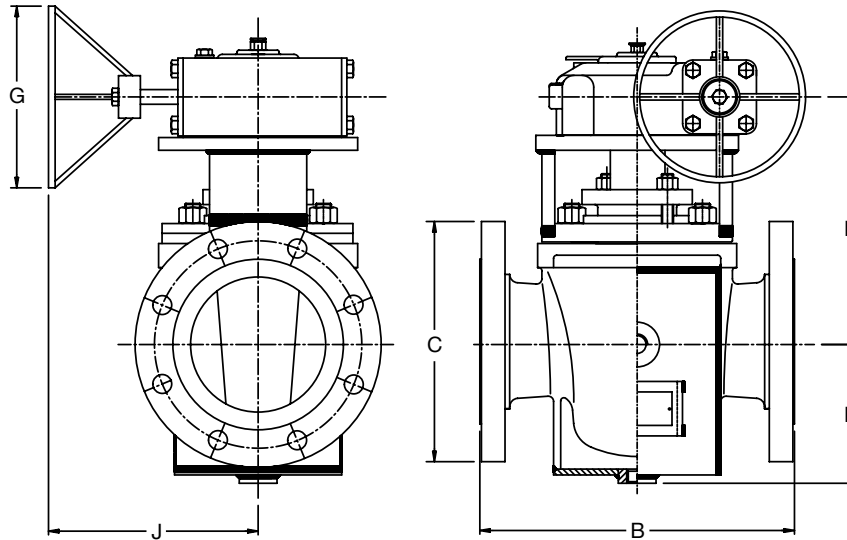

VCR 01R - Short with Gear

Size	NPS DN	Short Pattern			
		6 150	8 200	10 250	12 300
FACE TO FACE	<b>B</b> mm	267	292	330	356
FLANGE DIAMETER DIN PN 16	<b>C</b> mm	285	340	405	460
FLANGE DIAMETER ANSI 150 RF	<b>C</b> mm	279	343	406	483
N. TAPPED HOLES UNC THREADED IN FLANGES		2	2	2	4
CENTER LINE TO CENTER OF HANDWHEEL	<b>E</b> mm	570	600	630	690
CENTER LINE TO BOTTOM OF BODY	<b>F</b> mm	200	235	270	334
HANDWHEEL DIAMETER	<b>G</b> mm	560	560	560	560
LONGITUDINAL CENTER LINE TO FACE OF HANDWHEEL	<b>J</b> mm	330	330	450	450
STEAM/CONDENSATE N. HOLES $\frac{3}{4}$ " N.P.T.	<b>P</b>	3	3	3	3
WEIGHT	kg	140	180	230	325

# ANSI Class 150 (PN 20)

## Steam Jacketed Body

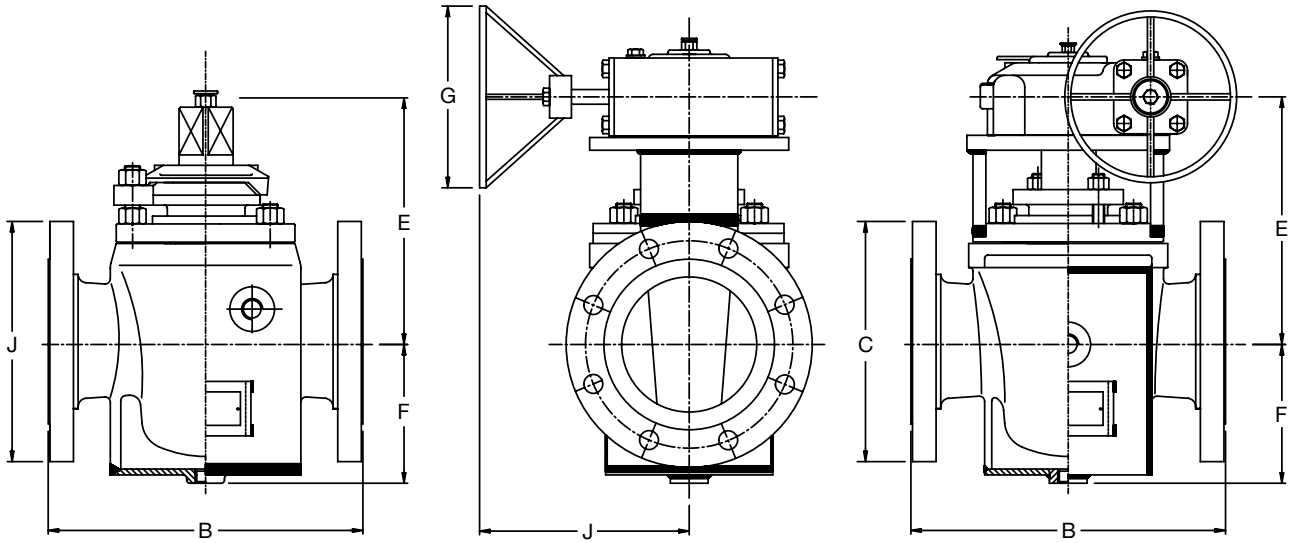

**VRC 01R - Regular with Wrench**

**VRR 01R - Regular with Gear**

Size	NPS DN	Regular Pattern							
		1½ 40	2 50	2½ 65	3 80	4 100	6 150	8 200	
FACE TO FACE	<b>B</b> mm	165	200	220	240	350	450	450	
FLANGE DIAMETER DIN PN 16	<b>C</b> mm	150	165	185	200	220	285	285	
FLANGE DIAMETER ANSI 150	<b>C</b> mm	127	152	178	191	229	279	279	
CENTER LINE TO TOP OF STEM	<b>E</b> mm	156	175	208	230	250	330	-	
CENTER LINE TO CENTER OF HANDWHEEL	<b>E</b> mm	-	-	-	-	-	-	650	
CENTER LINE TO BOTTOM OF BODY	<b>F</b> mm	97	115	130	145	180	245	245	
HANDWHEEL DIAMETER	<b>G</b> mm	-	-	-	-	-	560	560	
LONGITUDINAL CENTER LINE TO FACE OF HANDWHEEL	<b>J</b> mm	-	-	-	-	-	330	330	
STEAM/CONDENSATE N. HOLES ¾" N.P.T.	<b>P</b>	3	3	3	3	3	3	3	
WEIGHT	kg	14	22	30	36	80	154	175	
WRENCH - LENGHT	mm	320	400	500	570	720	-	-	

# ANSI Class 300 (PN 50)

## Steam Jacketed Body

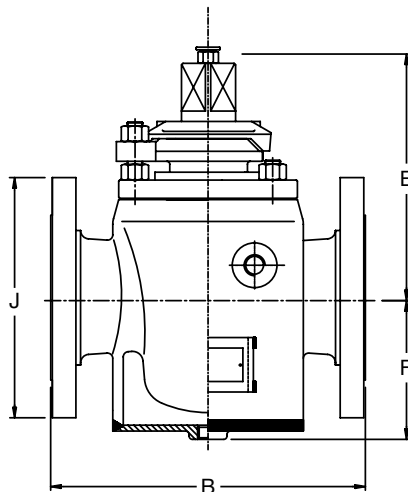

VCC 03R - Short with Wrench

Size	NPS DN	Short Pattern					
		1½ 40	2 50	2½ 65	3 80	4 100	
FACE TO FACE	<b>B</b> mm	190	216	241	283	305	
FLANGE DIAMETER DIN PN 40	<b>C</b> mm	150	165	185	200	235	
FLANGE DIAMETER ANSI 300 RF	<b>C</b> mm	156	165	191	210	254	
CENTER LINE TO TOP OF STEAM	<b>E</b> mm	156	175	208	230	250	
CENTER LINE TO BOTTOM OF BODY	<b>F</b> mm	97	115	130	145	180	
STEAM/CONDENSATE N. HOLES ¾" N.P.T.	<b>P</b>	3	3	3	3	3	
WEIGHT PN 40	kg	14	22	30	36	86	
WEIGHT ANSI 300	kg	17	23	32	42	95	
WRENCH - LENGHT	mm	320	400	500	570	720	

# ANSI Class 300 (PN 50)

## Steam Jacketed Body

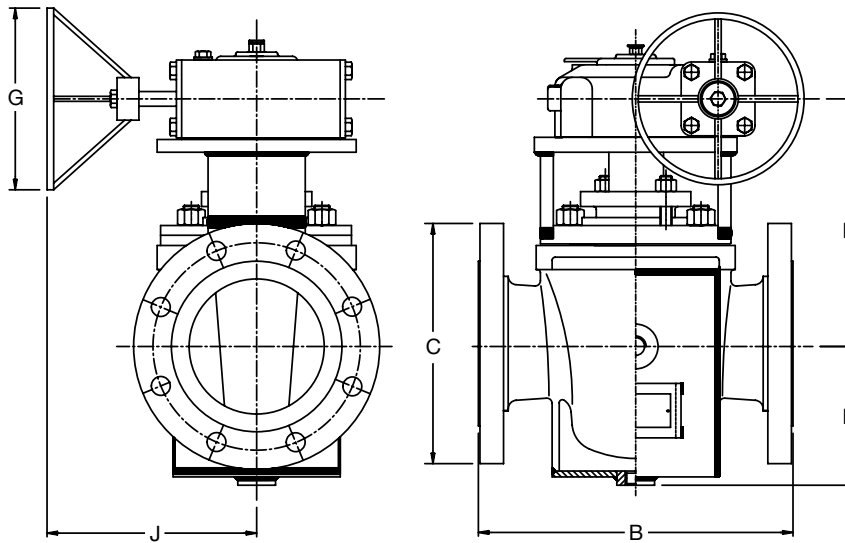

VCR 03R - Regular with Gear

Size	NPS DN	Short Pattern			
		6 150	8 200	10 250	12 300
FACE TO FACE	<b>B</b> mm	403	419	457	502
FLANGE DIAMETER DIN PN 40	<b>C</b> mm	300	375	450	515
FLANGE DIAMETER ANSI 300 RF	<b>C</b> mm	318	381	445	521
CENTER LINE TO TOP OF HANDWHEEL	<b>E</b> mm	575	615	645	700
CENTER LINE TO BOTTOM OF BODY	<b>F</b> mm	220	255	295	310
HANDWHEEL DIAMETER	<b>G</b> mm	560	560	560	560
LONGITUDINAL CENTER LINE TO FACE OF HANDWHEEL	<b>J</b> mm	330	330	450	450
STEAM/CONDENSATE N. HOLES $\frac{3}{4}$ " N.P.T.	<b>P</b>	3	3	33	
WEIGHT PN 40	kg	180	250	320	445
WEIGHT ANSI 300	kg	190	260	330	460

# ANSI Class 150 (PN 20)

## Full Jacketed Body

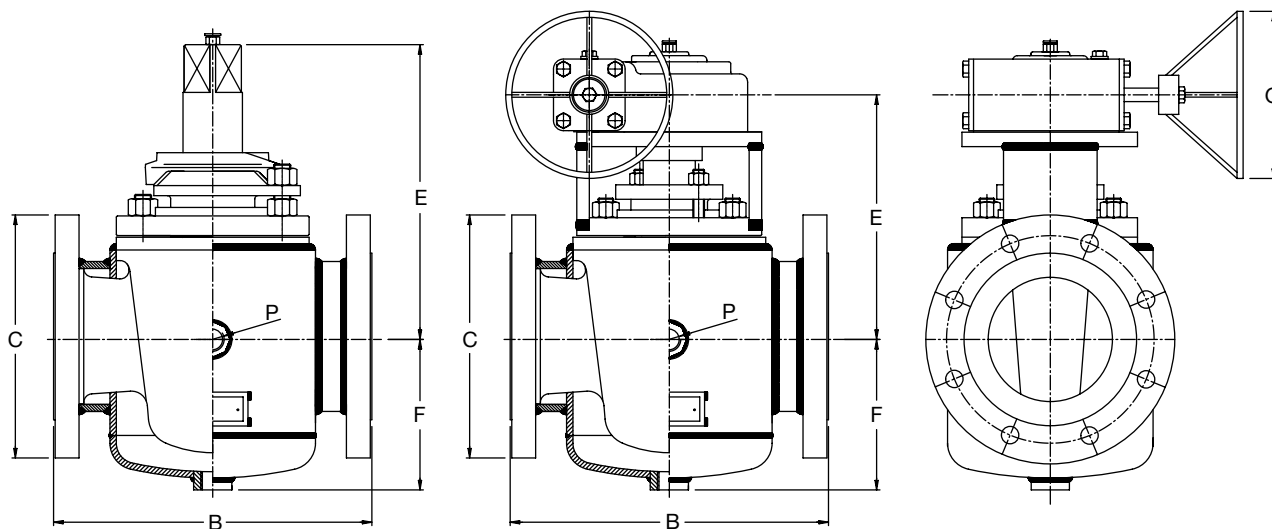

ZRC 01R - Regular with Wrench

ZRR 01R - Regular with Gear

### Regular Pattern

Size	NPS DN	1x2 25x50	1½ x 2½ 40x65	2x3 50x80	3x4 80x100	4x6 100x150	6x8 150x200	8x10 200x250
FACE TO FACE	<b>B</b> mm	200	220	240	300	390	419	457
FLANGE DIAMETER PN 16	<b>C</b> mm	165	185	200	220	285	340	405
FLANGE DIAMETER ANSI 150	<b>C</b> mm	152	178	191	229	279	343	406
CENTER LINE TO TOP OF STEM	<b>E</b> mm	120	156	175	230	245	--	
CENTER LINE TO BOTTOM OF BODY	<b>F</b> mm	75	97	115	145	175	220	260
CENTER LINE TO CENTER OF HANDWHEEL	<b>E</b> mm	-	-	-	-	-	500	615
HANDWHEEL DIAMETER	mm	-	-	-	-	-	560	560
STEAM/INLET N. 2 HOLES N.P.T.	<b>P<sub>1</sub> or P</b> in.	½ - ¾	¾ - 1	¾ - 1	¾ - 1	¾ - 1	¾ - 1	¾ - 1
CONDENSATE OUTLET N. 1 HOLE N.P.T.	<b>P<sub>2</sub></b> in.	¾	1	1	1	1	1	1
WRENCH - LENGHT	mm	235	320	400	570	720	-	-
WEIGHT	kg	13	20	27	45	115	210	270

# ANSI Class 150 (PN 20)

## Full Jacketed Body

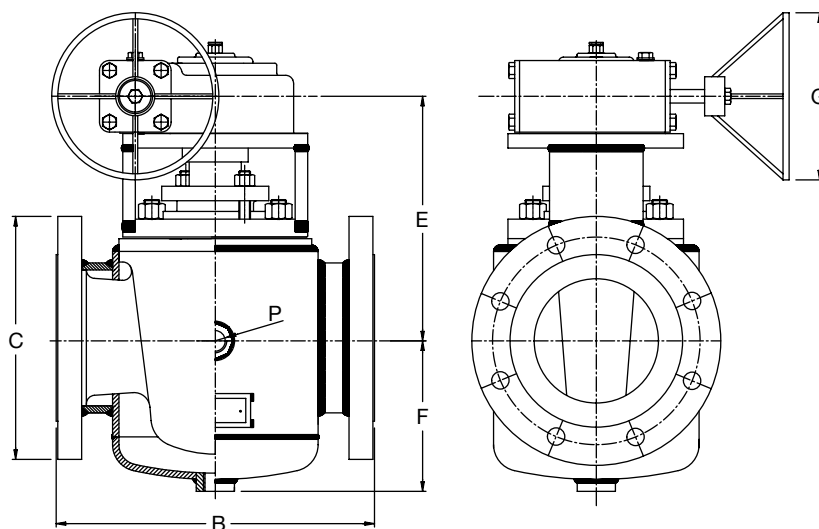

**ZRR 01R - Regular with Gear**

Size	Regular Pattern								
	NPS DN	10x12 250x300	12x14 300x350	14x16 350x400	16x18 400x450	18x20 450x500	20x24 500x600	24x26 600x650	
FACE TO FACE	<b>B</b> mm	502	762	762	838	914	991	1143	
FLANGE DIAMETER DIN PN 16	<b>C</b> mm	460	520	580	640	715	840	★	
FLANGE DIAMETER ANSI 150	<b>C</b> mm	483	533	597	635	699	813	870	
CENTER LINE TO BOTTOM OF BODY	<b>F</b> mm	380	400	445	465	525	590	675	
CENTER LINE TO CENTER OF HANDWHEEL	<b>E</b> mm	530	660	660	660	745	835	910	
HANDWHEEL DIAMETER	mm	800	1000	1000	1000	1000	1000	1000	
STEAM/INLET N. 2 HOLES N.P.T.	<b>P<sub>1</sub> or P</b> in.	3/4 - 1	3/4 - 1	3/4 - 1	3/4 - 1	3/4 - 1	3/4 - 1	3/4 - 1	
CONDENSATE OUTLET N. 1 HOLE N.P.T.	<b>P<sub>2</sub></b> in.	1	1	1	1	1	1	1	
WEIGHT	kg	360	525	690	965	1240	1480	2160	

\* **Note:** To be confirmed.

# ANSI Class 300 (PN 50)

## Full Jacketed Body

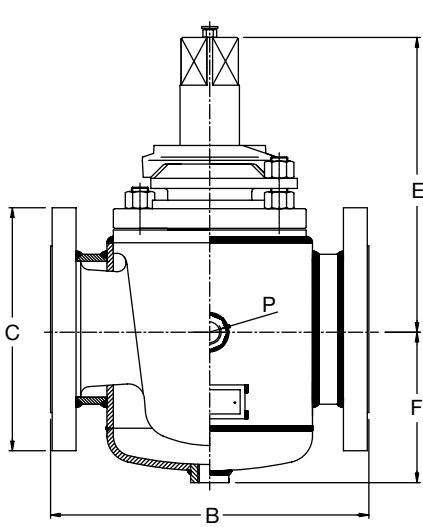

ZRC 03R - Regular with Wrench

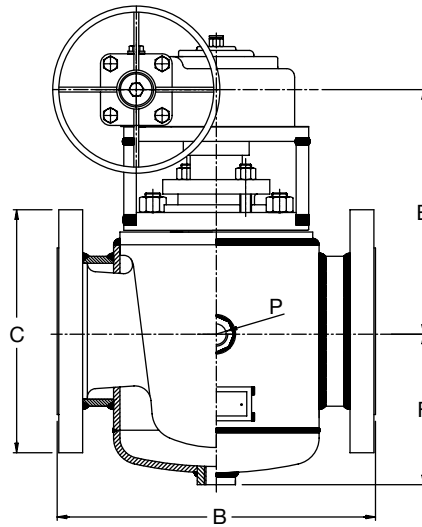

ZRR 03R - Regular with Gear

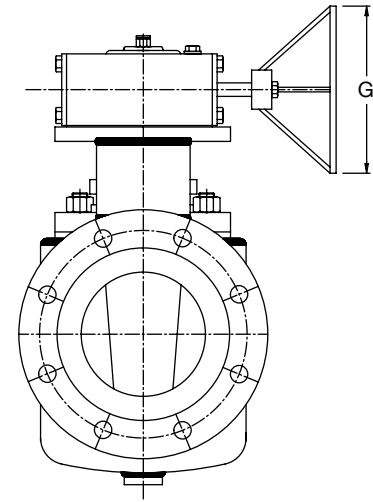

Size	NPS DN	Regular Pattern						
		1x2 25x50	1½x2½ 40x65	2x3 50x80	3x4 80x100	4x6 100x150	6x8 150x200	8x10 200x250
FACE TO FACE	<b>B</b> mm	200	240	260	300	403	419	457
FLANGE DIAMETER DIN PN 40	<b>C</b> mm	165	185	200	235	300	375	450
FLANGE DIAMETER ANSI 300	<b>C</b> mm	165	191	210	254	318	381	445
CENTER LINE TO TOP OF STEM	<b>E</b> mm	110	156	175	230	245	-	-
CENTER LINE TO BOTTOM OF BODY	<b>F</b> mm	70	97	115	145	175	220	260
CENTER LINE TO CENTER OF HANDWHEEL	<b>E</b> mm	-	-	-	-	-	500	615
HANDWHEEL DIAMETER	mm	-	-	-	-	-	700	800
STEAM/INLET N. 2 HOLES N.P.T.	<b>P<sub>1</sub> or P</b> in.	½ - ¾	¾ - 1	¾ - 1	¾ - 1	¾ - 1	¾ - 1	¾ - 1
CONDENSATE OUTLET N. 1 HOLE N.P.T.	<b>P<sub>2</sub></b> in.	¾	1	1	1	1	1	1
WEIGHT	kg	18	28	38	63	160	290	370
WRENCH - LENGHT	mm	300	300	400	570	720	-	-

# ANSI Class 300 (PN 50)

## Full Jacketed Body

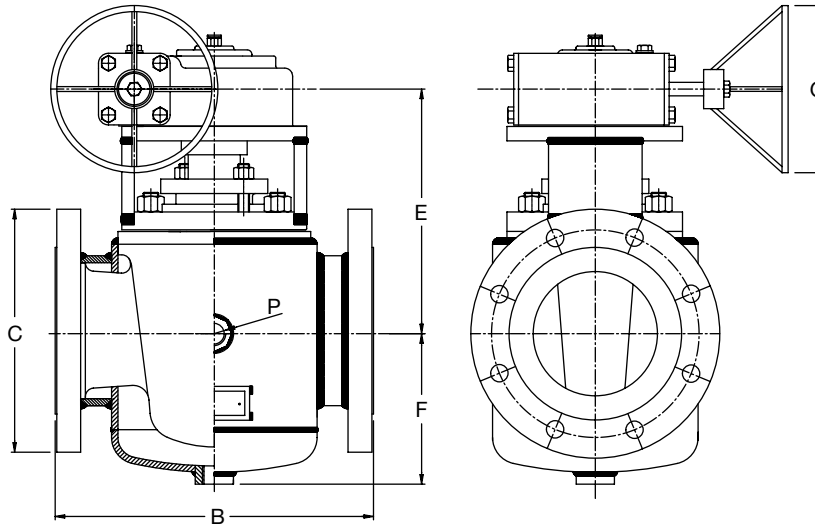

**ZRR 03R - Regular with Gear**

Size	Regular Pattern								
	NPS DN	10x12 250x300	12x14 300x350	14x16 350x400	16x18 450x500	18x20 450x500	20x24 500x600	24x26 600x650	
FACE TO FACE	<b>B</b>	mm	502	762	762	838	914	991	1143
FLANGE DIAMETER DIN PN 40	<b>C</b>	mm	515	580	660	685	755	890	★
FLANGE DIAMETER ANSI 300	<b>C</b>	mm	521	584	648	711	775	914	972
CENTER LINE TO BOTTOM OF BODY	<b>F</b>	mm	380	400	445	465	525	590	675
CENTER LINE TO CENTER OF HANDWHEEL	<b>E</b>	mm	521	660	660	660	745	835	915
HANDWHEEL DIAMETER		mm	800	800	1000	1000	1000	1000	1000
STEAM/INLET N. 2 HOLES N.P.T.	<b>P<sub>1</sub> or P</b>	in.	3/4 - 1	3/4 - 1	3/4 - 1	3/4 - 1	3/4 - 1	3/4 - 1	3/4 - 1
CONDENSATE OUTLET N. 1 HOLE N.P.T.	<b>P<sub>2</sub></b>	in.	1	1	1	1	1	1	1
WEIGHT		kg	420	570	720	985	1260	1780	2590

\* **Note:** To be confirmed.

# ANSI Class 150 (PN 20)

## Full Jacketed - Full Bore

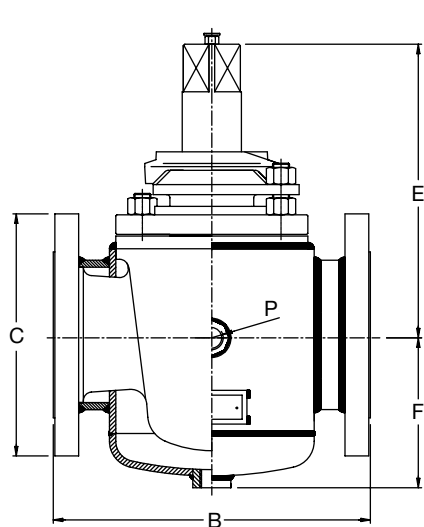

**ZFC 01R - Full with Wrench**

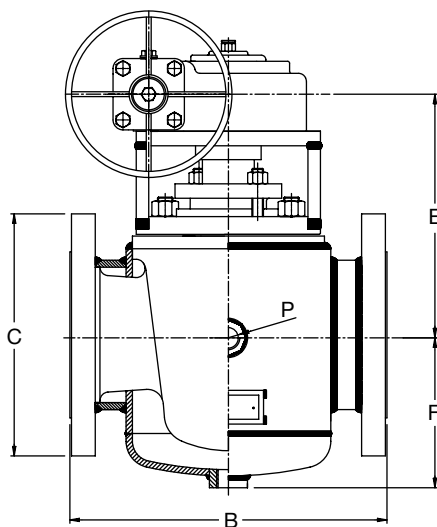

**ZFR 01R - Full with Gear**

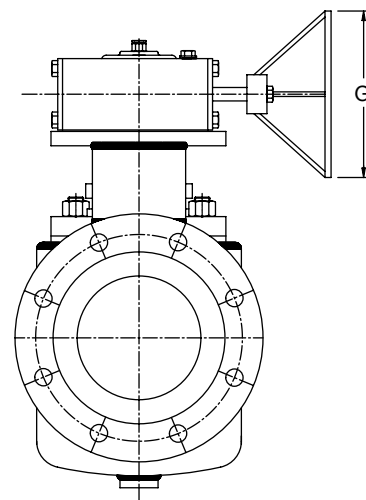

Size	NPS DN	Full Bore						
		1x2 25x50	2x3 50x80	3x4 80x100	4x6 100x150	6x8 150x200	8x10 200x250	10x12 250x300
FACE TO FACE	<b>B</b> mm	178	267	343	432	546	622	826
FLANGE DIAMETER DIN PN 16	<b>C</b> mm	165	200	220	285	340	405	460
FLANGE DIAMETER ANSI 150	<b>C</b> mm	153	191	229	280	343	406	483
CENTER LINE TO TOP OF STEM	<b>E</b> mm	110	185	205	240	-	-	-
CENTER LINE TO BOTTOM OF BODY	<b>F</b> mm	70	120	140	178	220	235	526
CENTER LINE TO CENTER OF HANDWHEEL	<b>E</b> mm	-	-	-	-	340	390	504
HANDWHEEL DIAMETER	mm	-	-	-	-	-	800	800
STEAM/INLET N. 2 HOLES N.P.T.	<b>P<sub>1</sub> or P</b> in.	1/2 - 3/4	3/4 - 1	3/4 - 1	3/4 - 1	3/4 - 1	3/4 - 1	3/4 - 1
CONDENSATE OUTLET N. 1 HOLE N.P.T.	<b>P<sub>2</sub></b> in.	3/4	1	1	1	1	1	1
WRENCH - LENGHT	mm	300	500	500	550	-	-	-

# ANSI Class 300 (PN 50)

## Full Jacketed - Full Bore

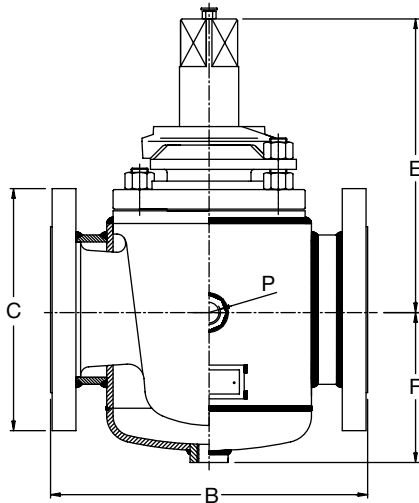

ZFC 03R - Full with Wrench

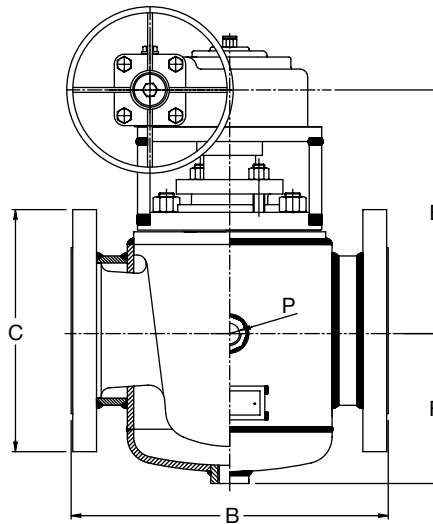

ZFR 03R - Full with Gear

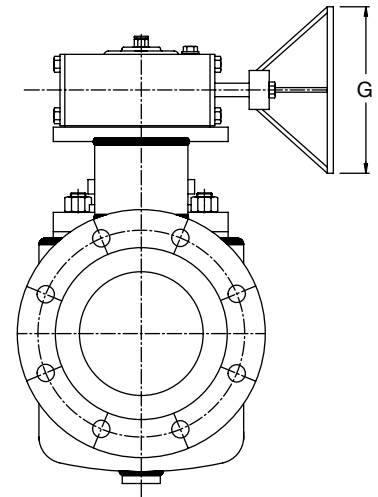

Size	NPS DN	Full Bore						
		1x2 25x50	2x3 50x80	3x4 80x100	4x6 100x150	6x8 150x200	8x10 200x250	10x12 250x300
FACE TO FACE	<b>B</b> mm	191	283	387	457	559	686	826
FLANGE DIAMETER DIN PN 40	<b>C</b> mm	165	200	235	300	375	450	515
FLANGE DIAMETER ANSI 300	<b>C</b> mm	165	210	254	318	381	445	521
CENTER LINE TO TOP OF STEM	<b>E</b> mm	110	185	205	240	-	-	-
CENTER LINE TO BOTTOM OF BODY	<b>F</b> mm	70	120	140	178	220	235	526
CENTER LINE TO CENTER OF HANDWHEEL	<b>E</b> mm	-	-	-	-	340	390	504
HANDWHEEL DIAMETER	mm	-	-	-	-	-	800	800
STEAM/INLET N. 2 HOLES N.P.T.	<b>P<sub>1</sub> or P</b> in.	1/2 - 3/4	3/4 - 1	3/4 - 1	3/4 - 1	3/4 - 1	3/4 - 1	3/4 - 1
CONDENSATE OUTLET N. 1 HOLE N.P.T.	<b>P<sub>2</sub></b> in.	3/4	1	1	1	1	1	1
WRENCH - LENGHT	mm	300	500	500	550	-	-	-

Алматы (7273)495-231  
 Ангарск (3955)60-70-56  
 Архангельск (8182)63-90-72  
 Астрахань (8512)99-46-04  
 Барнаул (3852)73-04-60  
 Белгород (4722)40-23-64  
 Благовещенск (4162)22-76-07  
 Брянск (4832)59-03-52  
 Владивосток (423)249-28-31  
 Владикавказ (8672)28-90-48  
 Владимир (4922) 49-43-18  
 Волгоград (844)278-03-48  
 Вологда (8172)26-41-59  
 Воронеж (473)204-51-73  
 Екатеринбург (343)384-55-89

Ижевск (3412)26-03-58  
 Иваново (4932)77-34-06  
 Иркутск (395)279-98-46  
 Казань (843)206-01-48  
 Калининград (4012)72-03-81  
 Калуга (4842)92-23-67  
 Кемерово (3842)65-04-62  
 Киров (8332)68-02-04  
 Коломна (4966)23-41-49  
 Кострома (4942)77-07-48  
 Краснодар (861)203-40-90  
 Красноярск (391)204-63-61  
 Курск (4712)77-13-04  
 Курган (3522)50-90-47  
 Липецк (4742)52-20-81

Киргизия (996)312-96-26-47

Магнитогорск (3519)55-03-13  
 Москва (495)268-04-70  
 Мурманск (8152)59-64-93  
 Набережные Челны (8552)20-53-41  
 Нижний Новгород (831)429-08-12  
 Новокузнецк (3843)20-46-81  
 Ноябрьск (3496)41-32-12  
 Новосибирск (383)227-86-73  
 Ноябрьск (3496)41-32-12  
 Омск (3812)21-46-40  
 Орел (4862)44-53-42  
 Оренбург (3532)37-68-04  
 Пенза (8412)22-31-16  
 Петрозаводск (8142)55-98-37  
 Псков (8112)59-10-37

Россия (495)268-04-70

Пермь (342)205-81-47  
 Ростов-на-Дону (863)308-18-15  
 Рязань (4912)46-61-64  
 Самара (846)206-03-16  
 Санкт-Петербург (812)309-46-40  
 Саратов (845)249-38-78  
 Севастополь (8692)22-31-93  
 Симферополь (3652)67-13-56  
 Смоленск (4812)29-41-54  
 Сочи (862)225-72-31  
 Ставрополь (8652)20-65-13  
 Сыктывкар (8212)25-95-17  
 Сургут (3462)77-98-35  
 Тамбов (4752)50-40-97

Казахстан (772)734-952-31

Тверь (4822)63-31-35  
 Тольятти (8482)63-91-07  
 Томск (3822)98-41-53  
 Тула (4872)33-79-87  
 Тюмень (3452)66-21-18  
 Улан-Удэ (3012)59-97-51  
 Ульяновск (8422)24-23-59  
 Уфа (347)229-48-12  
 Хабаровск (4212)92-98-04  
 Чебоксары (8352)28-53-07  
 Челябинск (351)202-03-61  
 Череповец (8202)49-02-64  
 Чита (3022)38-34-83  
 Якутск (4112)23-90-97  
 Ярославль (4852)69-52-93